

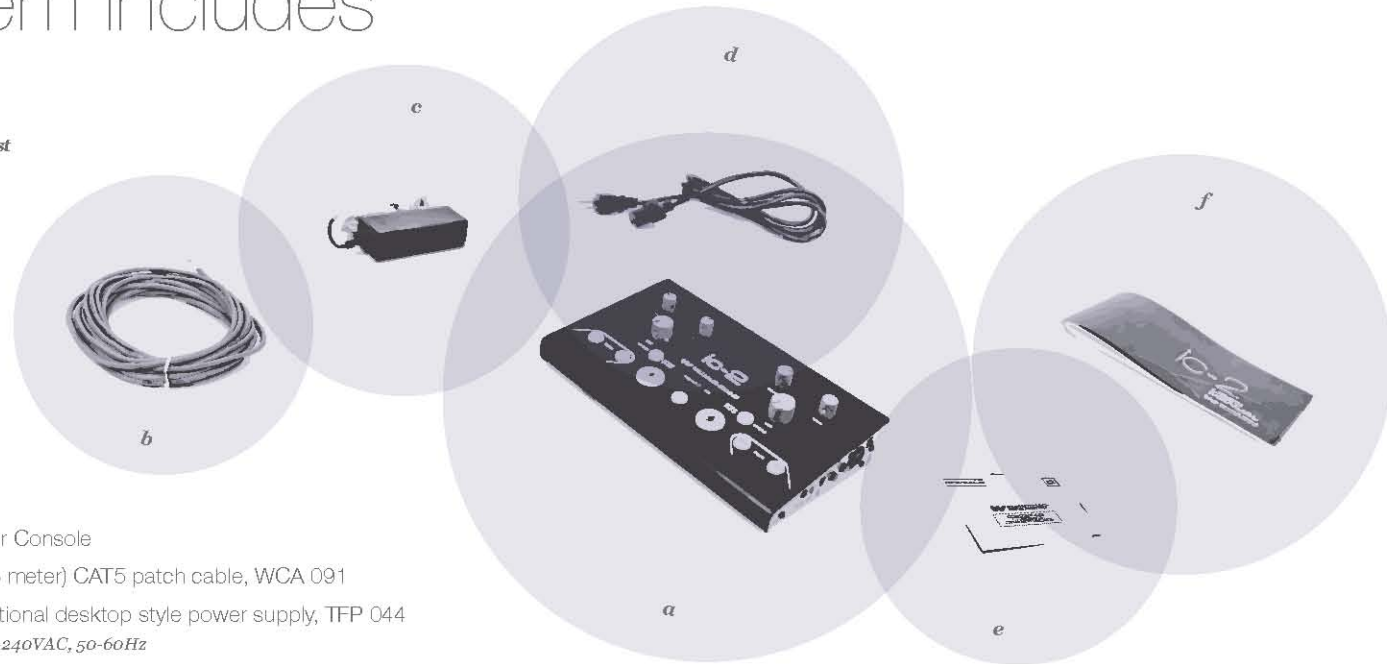

System Includes

Figure 1: Packing List



a · IC-2 Interpreter Console

b · (1) 25 foot (7.6 meter) CAT5 patch cable, WCA 091

c · 18VDC international desktop style power supply, TFP 044
Operates on 100-240VAC, 50-60Hz

d · Power supply line cord, WLC 004 (US), WLC 005 (EU), WLC 006 (UK), or WLC 007 (AU)

e · 5-year Warranty Card, FRM 404

f · Manual and user guide, MAN 152



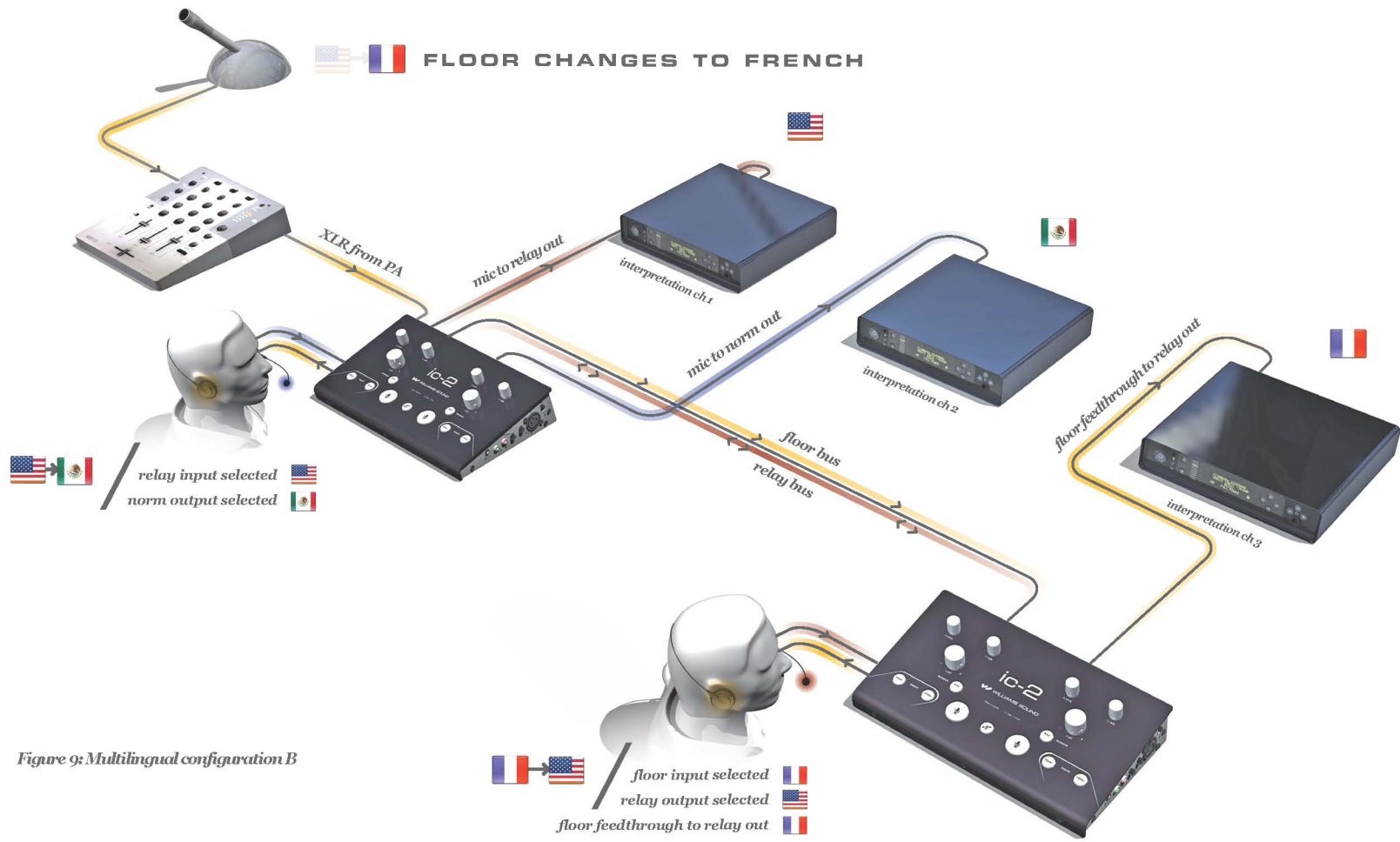

Figure 9: Multilingual configuration B